

海南陵水黎安国际教育创新试验区公共交通运输建设项目用地勘测界定图

2035.03-396.19

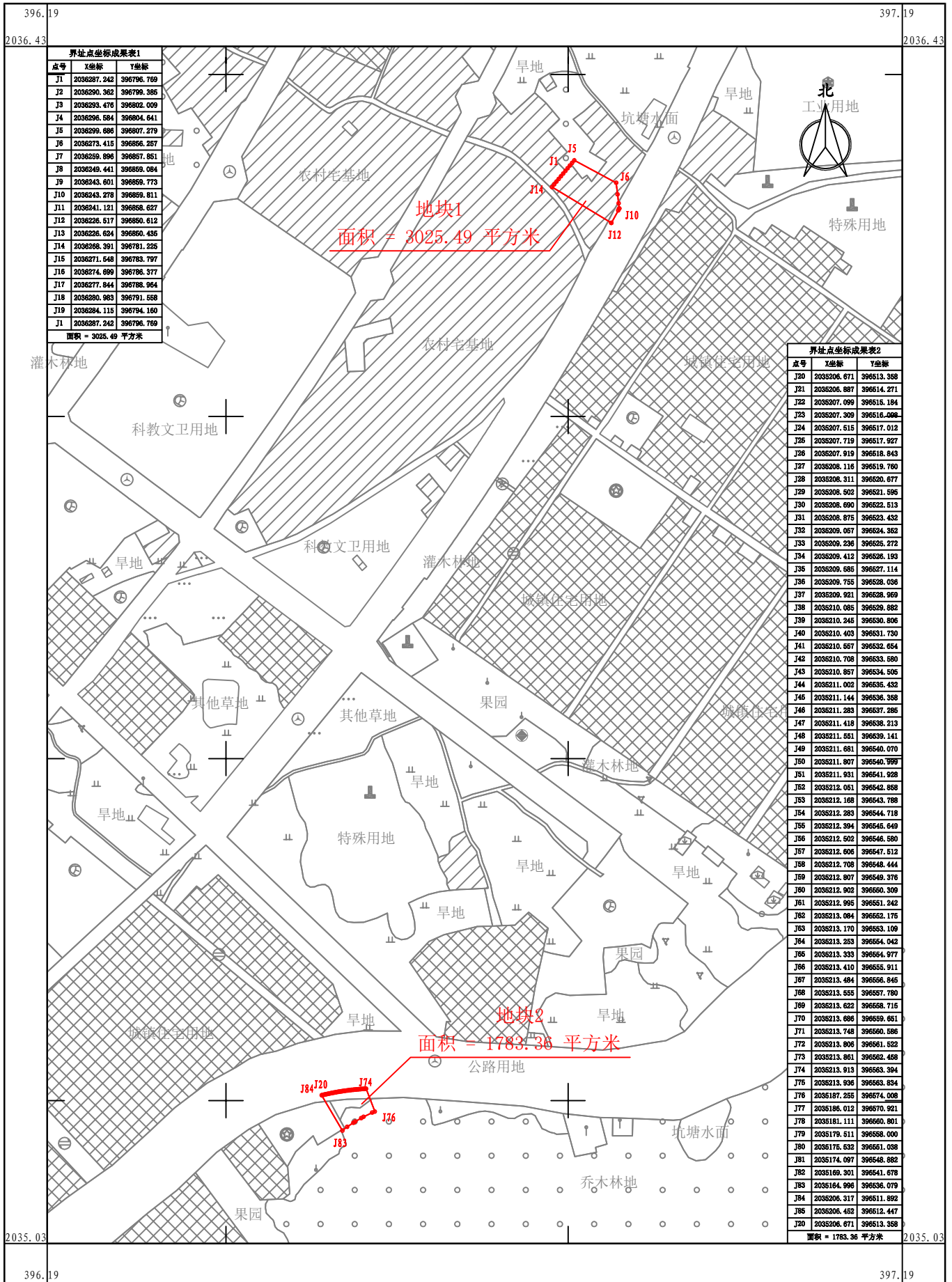

点号	X坐标	Y坐标
J1	2036287.242	396796.769
J2	2036290.362	396799.385
J3	2036293.476	396802.009
J4	2036296.594	396804.641
J5	2036299.696	396807.279
J6	2036273.415	396856.257
J7	2036259.896	396857.851
J8	2036249.441	396859.084
J9	2036243.601	396859.773
J10	2036243.278	396859.811
J11	2036241.121	396858.627
J12	2036226.517	396850.612
J13	2036226.624	396850.435
J14	2036268.391	396781.225
J15	2036271.648	396783.797
J16	2036274.699	396786.377
J17	2036277.844	396788.954
J18	2036280.983	396791.558
J19	2036284.115	396794.160
J1	2036287.242	396796.769

面积 = 3025.49 平方米

点号	X坐标	Y坐标
J20	2036206.671	396513.358
J21	2036206.887	396514.271
J22	2036207.099	396515.184
J23	2036207.309	396516.098
J24	2036207.515	396517.012
J25	2036207.719	396517.927
J26	2036207.919	396518.843
J27	2036208.116	396519.760
J28	2036208.311	396520.677
J29	2036208.502	396521.595
J30	2036208.690	396522.513
J31	2036208.875	396523.432
J32	2036209.057	396524.352
J33	2036209.236	396525.272
J34	2036209.412	396526.193
J35	2036209.585	396527.114
J36	2036209.755	396528.036
J37	2036209.921	396528.959
J38	2036210.085	396529.882
J39	2036210.245	396530.806
J40	2036210.403	396531.730
J41	2036210.557	396532.654
J42	2036210.708	396533.580
J43	2036210.857	396534.505
J44	2036211.002	396535.432
J45	2036211.144	396536.358
J46	2036211.283	396537.286
J47	2036211.418	396538.213
J48	2036211.551	396539.141
J49	2036211.681	396540.070
J50	2036211.807	396540.999
J51	2036211.931	396541.928
J52	2036212.051	396542.858
J53	2036212.168	396543.788
J54	2036212.283	396544.718
J55	2036212.394	396545.649
J56	2036212.502	396546.580
J57	2036212.606	396547.512
J58	2036212.708	396548.444
J59	2036212.807	396549.376
J60	2036212.902	396550.309
J61	2036212.995	396551.242
J62	2036213.084	396552.176
J63	2036213.170	396553.109
J64	2036213.253	396554.042
J65	2036213.333	396554.977
J66	2036213.410	396555.911
J67	2036213.484	396556.845
J68	2036213.555	396557.780
J69	2036213.622	396558.716
J70	2036213.686	396559.651
J71	2036213.748	396560.586
J72	2036213.806	396561.522
J73	2036213.861	396562.458
J74	2036213.913	396563.394
J75	2036213.936	396563.834
J76	2036187.255	396574.008
J77	2036186.012	396570.921
J78	2036181.111	396560.801
J79	2036179.511	396558.000
J80	2036176.532	396561.038
J81	2036174.097	396548.882
J82	2036169.301	396541.678
J83	2036164.996	396536.079
J84	2036206.671	396513.358

面积 = 1783.36 平方米

海南国源土地矿产勘测规划设计院有限公司

2024年06月数字化测图
2000国家大地坐标系
1985国家高程基准

1:2000